

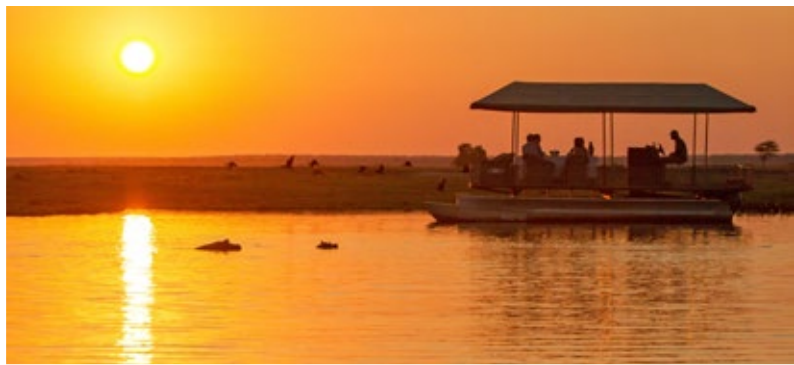

CHOBE SAVANNA LODGE

Zambezi Region, Namibia



Empowering Botswana Through Tourism

CAMP OKAVANGO | XUGANA ISLAND LODGE | CAMP MOREMI | CAMP XAKANAXA
CHOBE GAME LODGE | SAVUTE SAFARI LODGE | CHOBE SAVANNA LODGE | LEROO LA TAU



www.desertdelta.com

OCTOBER 2020

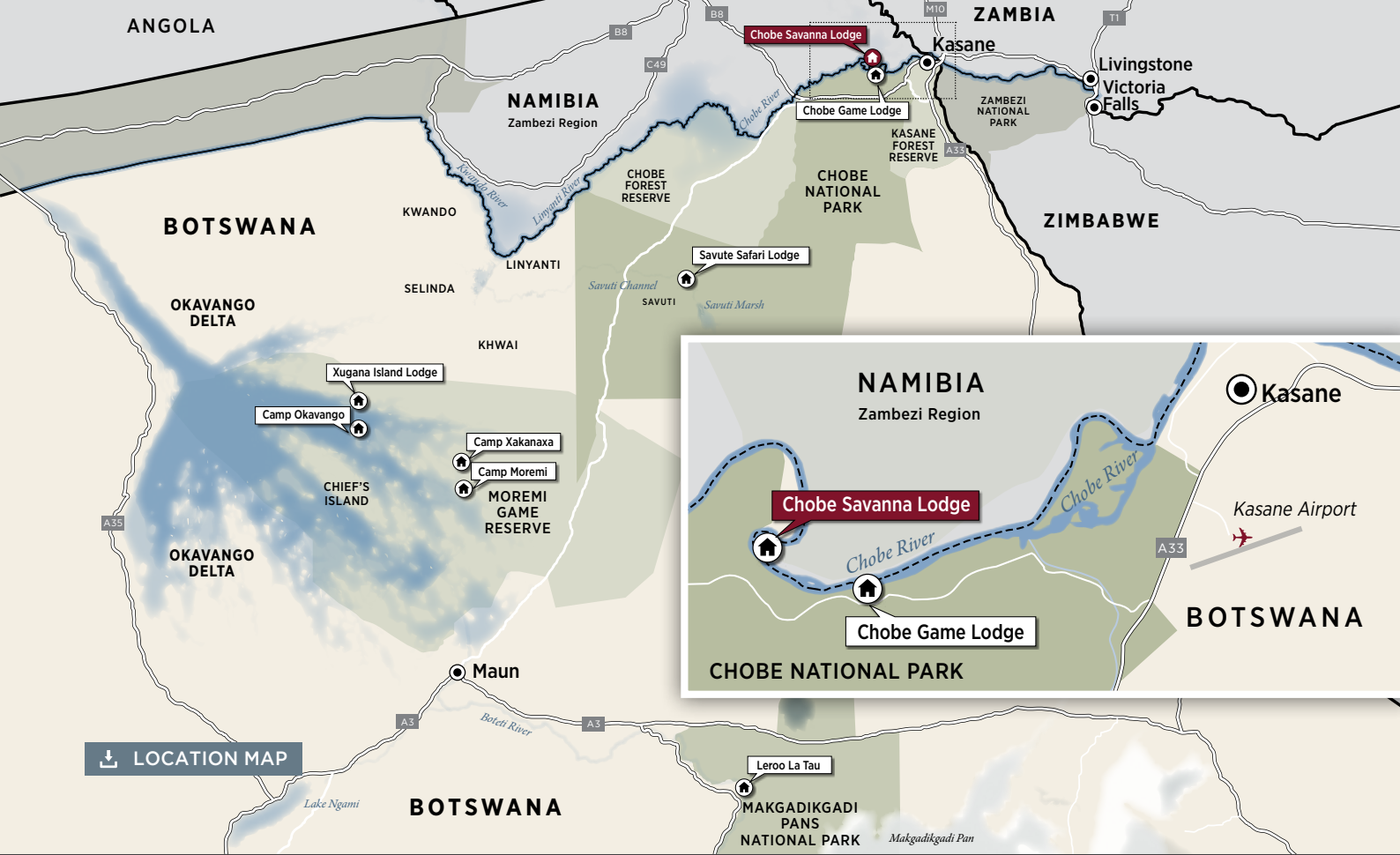

LOCATION MAP

Situated in the Eastern Zambezi region of Namibia, a narrow strip of country on the northern bank of the Chobe River, Chobe Savanna Lodge overlooks the vast floodplains of the Chobe National Park's Puku Flats.



CAMP LAYOUT



THE CAMP



FACILITIES

ROOMS	10 Twin bedded chalets, 2 sets of inter leading rooms (family friendly) & 1 Family room accommodating a maximum of 26 guests.
PILOT/GUIDE	N/A
RATES	Fully inclusive of all meals, scheduled safari activities, local drinks (including alcoholic drinks, excluding premium brands), park/admin fees and a complimentary minibar fridge in each chalet.
DINING	Various indoor and outdoor dining locations.
CAMP FIRE	Located just in front of the main area of the lodge.
SWIMMING POOL	Located in the gardens in the middle of the island.
VIEWING DECK	Superb view of the Chobe River and surrounding floodplains of the island, overlooking the Chobe National Park.
BAR	Fully stocked bar.
CURIO SHOP	Accepts cash and credit card payments.
LAUNDRY	Daily, inclusive laundry service available.
WATER	Reverse osmosis water treatment plant supplies drinking water (bottled water on request).
ELECTRICITY	Is supplied via Botswana's national grid, and AC 220V mains power is available 24 hours a day. The standby generator automatically switches on whenever a power failure occurs.
INTERNET	Wi-Fi available.
TELEPHONE	Telephone calls can be made using mobile phones or whatsapp.
CHILDREN	Accepts children of all ages. See Desert & Delta Safaris child policy for more information.

 [CAMP IMAGES](#)



ACCOMMODATION

A private and secluded safari experience is guaranteed as Chobe Savanna Lodge accommodates only 26 guests in beautifully furnished thatched chalets, each with a private deck, an integrated bedroom and lounge area and en-suite facilities. Every chalet is air-conditioned and has its own complimentary mini bar.



STANDARD ROOM

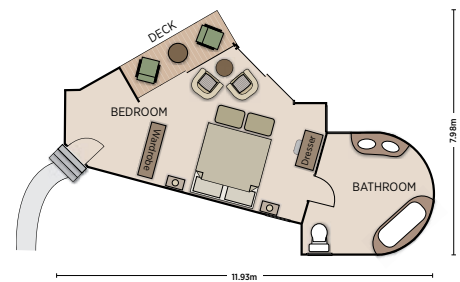

ROOM FACILITIES

PRIVATE VERANDA	Each chalet has its own private deck.
EN-SUITE BATHROOM	CHALET: shower, hand basin and toilet.
	FAMILY ROOM: large bathroom with shower, bath tub, vanity and toilet.
FANS & AIR-CONDITIONING	All rooms are air-conditioned and have fans.
POWER	220V multi adaptor plugs for charging photographic equipment.
SAFE	The safe is a lockable steel cabinet with its own key.
UMBRELLA	In case of rain.
AIR HORN	For use in case of an emergency.
HAIRDRYER	A small hairdryer is available in each room.
BATHROOM AMENITIES	A range of bathroom amenities including biodegradable soaps, shower gels etc.
TEA & COFFEE FACILITIES	A small kettle with tea and coffee available.

FAMILY ROOM

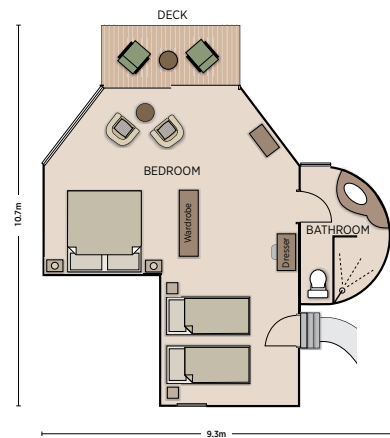

INTER-LEADING FAMILY ROOM

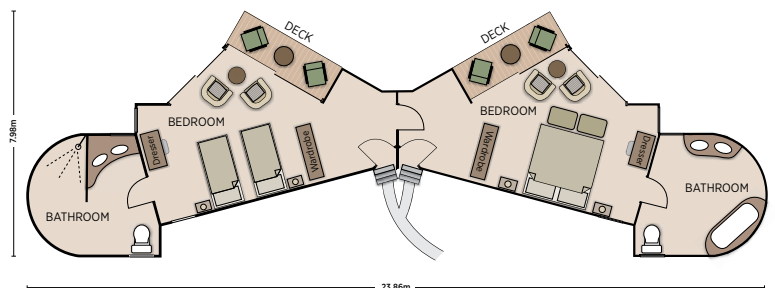







CAMP IMAGES



↓ PLANS



ACTIVITIES

	MOTORISED BOAT SAFARIS	River excursions in small, easily maneuverable boats are ideal for close encounters with the wild visitors to the river's edge, in hard-bottom aluminum boats. The boats are equipped with comfortable seats, a foldaway canvas roof and life jackets.
	SKIMMER BRUNCH CRUISE	Guests can enjoy a relaxing brunch cruise on the skimmer boat for a chance to dine on the Chobe River while taking in the beautiful surroundings and exceptional wildlife.
	FISHING	Fishing is also a popular pastime; our catch-and-release fishing trips for Bream or Tiger fish (seasonal).
	CULTURAL EXCURSIONS	Those wishing to experience some of the local Namibian traditions will enjoy a cultural village visit to one of the surrounding communities.
	BIRD WATCHING	Bird watching and photographic safaris are ideal from Chobe Savanna Lodge (please contact us to arrange special packages).
	GUIDED NATURE WALKS	Along the floodplain (seasonal).

 EXPERIENCE IMAGES

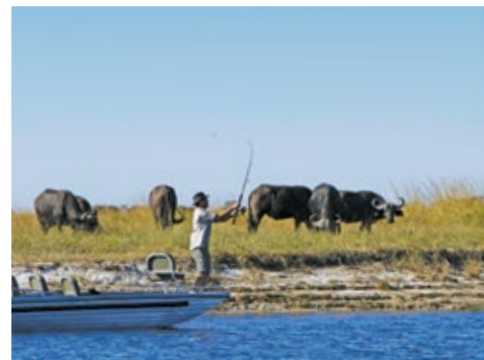

TYPICAL DAY ON SAFARI

Please note the below suggested daily program is flexible based on the guests interests, travel times and availability of activities.

TIMES	ACTIVITY
06:15	Early morning cruise with tea, coffee & biscuits on the boat
08:00 - 08:30	Continental breakfast with eggs of your choice
09:30 - 12:30	Morning activity
13:00 - 14:00	Lunch
14:00 - 15:00	SIESTA TIME - Relax and enjoy the lodge facilities & surroundings
15:30	Afternoon tea and coffee followed by a river safari and sundowner cruise
19:30	Dinner is served





ACCESS TO CHOBE SAVANNA LODGE

Chobe Savanna Lodge is accessed via Kasane in Botswana by boat transfer. Upon arrival at the Kasane Airport from either international or scheduled flight, there is a road transfer (arranged by Desert & Delta Safaris) from the airport to Kasane Immigration jetty (approximately 10 minutes). After being met by your Chobe Savanna Lodge guide and Immigration procedures are complete, it is approximately 1 hour transfer by motorized boat up the Chobe River. The transfer includes a short stop at the Namibian immigration office for passport procedures.

Guests arriving from Victoria Falls/Livingstone should be transferred directly to the Kasane Immigration jetty in town.

SELF-DRIVE GUESTS

As the lodge is only accessible by boat guests should make their own arrangements to get to the Kasane Immigration jetty. There are no parking facilities at immigration but please contact us for further information pertaining to vehicles.



Maun

ESTIMATED FLIGHT TIMES Between Camps & Airports

25	Camp Okavango					
30	5	Xugana Island Lodge				
20	10	10	Camp Moremi / Camp Xakanaxa			
40	30	25	25	Savute Safari Lodge		
30	45	45	40	50	Leroo La Tau	
70	60	60	55	30	65	Kasane

Clients connecting to Chobe Savanna Lodge on a Desert & Delta Safaris circuit will fly to or from Kasane airport. Remember the additional transfer time from Kasane Airport to Chobe Savanna Lodge via Kasane Immigration - allow for approximately 1.5 hours total transfer time from Kasane Airport.

PLEASE NOTE: Drone use is strictly prohibited at Chobe Savanna Lodge due to the sensitive environment in which the lodge operates.



Empowering Botswana Through Tourism

RESERVATIONS OFFICE

TELEPHONE [+267] 680 1494
E-MAIL info@desertdelta.com

View Desert & Delta Safaris Video

MARKETING OFFICE

TELEPHONE [+267] 686 1559
E-MAIL marketing@desertdelta.com
ADDRESS Private Bag 310,
Maun, Botswana

www.desertdelta.com